

ABS Module 850 V70 S70 C70

The **ABS Module 850 V70 S70 C70** refers to the Anti-lock Braking System control module used in select Volvo models, specifically the **850 (1993-1997), V70, S70, and C70 (1998-2000)**. This module monitors wheel speed sensors and helps prevent wheel lockup during braking by modulating brake pressure. Common issues with this module include intermittent ABS warning lights, non-functioning speedometers, or traction control problems, often due to internal solder joint failures. Replacement or repair of the module restores proper ABS and traction control functionality.

- [ABS Module 850 V70 S70 C70](#)
- [Wheel Speed Sensor 1996-1997 Volvo 850 and 850R & 1998 Volvo V70, V70R, XC70, S70, C70](#)

ABS Module 850 V70 S70 C70

1996-1997 Volvo 850 With TRACS &
1998 Volvo V70, V70R, XC70, S70,
C70 With Tracs



Part numbers are identical/compatible
9162675
9140774
8602266

Vehicles with TRACS have a TRACS OFF light and a TRACS button to the right of the steering wheel.

1996-1997 Volvo 850, Without TRACS & 1998 Volvo V70, S70, C70 Without TRACS



Part numbers are identical/compatible

9140773

8602265

1999-2000 Volvo S70, V70, C70

1999-2000 VOLVO S70,V70,C70 WITH STC TRACTION CONTROL



Part numbers are identical/compatible
9472088
9472401
9472866
9472971
9496440
9496946
8619538
8619545

For all S70,V70,C70 models with optional STC-traction control. Vehicles with STC have a switch labeled "STC" to the right of the steering wheel on the dashboard. The "W" button on your center console is NOT STC traction control.

1999-2000 VOLVO S70,V70R, XC70,V70 WITH TRACS TRACTION CONTROL



Part numbers are identical/compatible
8622093
9472100
9472650

9496450
8622097

This is only for cars with All Wheel Drive (AWD), and 99-2000 Front Wheel Drive S70,V70R, XC70,V70 with TRACS traction control. Vehicles with TRACS have a switch labeled "TRACS" to the right of the steering wheel. AWD cars have TRACS by default without a button/switch. The "W" button on your center console is not traction control.

1999-2000 VOLVO S70,V70,C70 WITHOUT TRACTION CONTROL



Part numbers are identical/compatible
9467582
9472095
9472969
9496942
8619535
8619544

This is only for FWD cars without optional traction control. The "W" button on your center console is not traction control.

Source

<https://midwest-abs.com/>

Wheel Speed Sensor 1996-1997 Volvo 850 and 850R & 1998 Volvo V70, V70R, XC70, S70, C70

Sensor Resistance

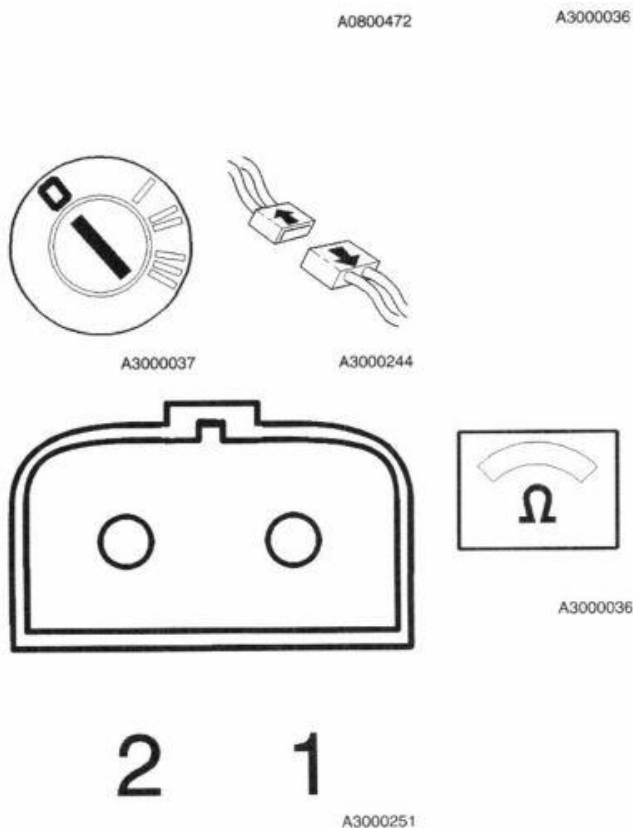

FC3

Check for resistance in the wheel sensor

- Ignition off
- Remove the wheel for better access
- Clean the wheel sensor contact Brush and blow clean
- Disconnect the wheel sensor

Connect an ohmmeter between wheel sensor contact connections 1 and 2.

The ohmmeter should indicate 1040–1160 Ω .

If reading is OK:

- FC4

If reading is incorrect:

- FC5

FC4

Check for contact resistance and oxidation

The DTC has been caused by poor contact in the wheel sensor contact

Check the wheel sensor contact for contact resistance and oxidation and take appropriate action as per III B5.

Then continue with:

- FC18

Sensor Voltage



A3000040



A2800152

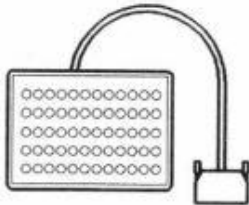

A0600472

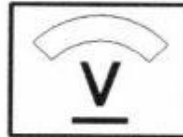

A3000031

Check the signal leads

- Ignition off
- Connect the control module
- Ignition on

Connect a voltmeter between the test box:

#8 and #4 (DTC ABS-211).

#8 and #3 (DTC ABS-212).

The voltmeter should indicate 2,3 V.

If reading is OK:

- FC9

If value is lower:

- FC7

If value is higher:

- FC8