

# Wheel Speed Sensor 1996-1997 Volvo 850 and 850R & 1998 Volvo V70, V70R, XC70, S70, C70

## Sensor Resistance

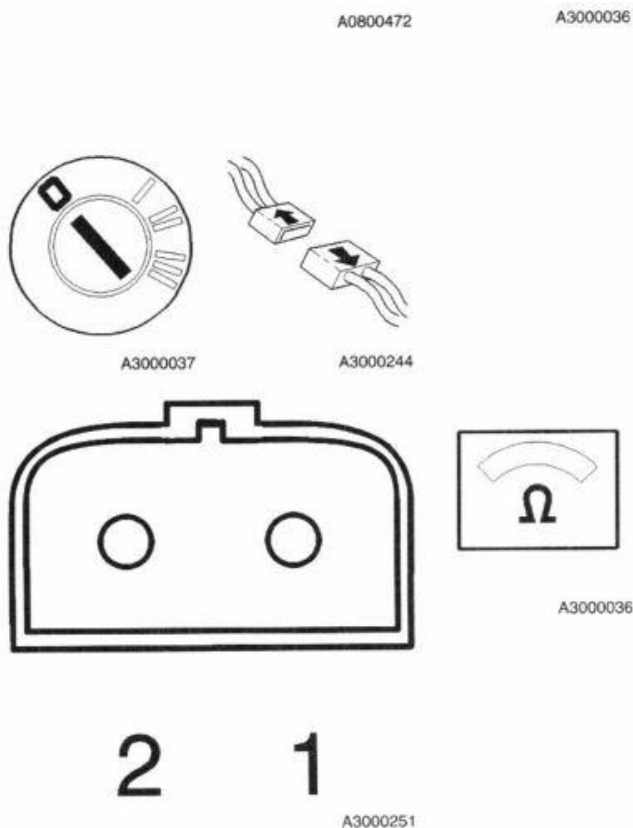

FC3

### Check for resistance in the wheel sensor

- Ignition off
- Remove the wheel for better access
- Clean the wheel sensor contact Brush and blow clean
- Disconnect the wheel sensor

Connect an ohmmeter between wheel sensor contact connections 1 and 2.

The ohmmeter should indicate 1040–1160  $\Omega$ .

If reading is OK:

- FC4

If reading is incorrect:

- FC5

FC4

### Check for contact resistance and oxidation

The DTC has been caused by poor contact in the wheel sensor contact

Check the wheel sensor contact for contact resistance and oxidation and take appropriate action as per III B5.

Then continue with:

- FC18

## Sensor Voltage



A3000040



A2800152

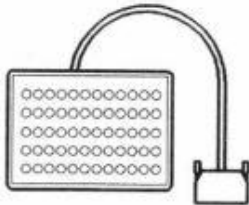

A0600472

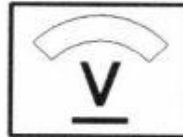

A3000031

### Check the signal leads

- Ignition off
- Connect the control module
- Ignition on

Connect a voltmeter between the test box:

#8 and #4 (DTC ABS-211).

#8 and #3 (DTC ABS-212).

The voltmeter should indicate 2,3 V.

**If reading is OK:**

- FC9

**If value is lower:**

- FC7

**If value is higher:**

- FC8

Revision #3

Created 2025-12-09 19:09:44 UTC by Kyle Robertson

Updated 2025-12-09 19:13:06 UTC by Kyle Robertson